

BROKERAGE . LAND DISPOSITION

PROJECT Westlakes
LAND SIZE 530± acres
REAL ESTATE TYPE Multi-use land tract : single family
LOCATION SW Bexar County - fronting Loop 1604 W & Medina River, just south of Hwy 90 W

SERVICES PROVIDED

Owner representative in land disposition.

PROJECT OVERVIEW

Unique multi-use development tract with frontage on Loop 1604 W and the Medina River. Several large lakes, smaller lakes and gently rolling topo.

RESULTS ACHIEVED

Negotiated 530± acre land sale to residential land developers for multi-phase takedown purchase. Sullivan was involved in the process of assisting with easement acquisition for 4+ mile water line extension to serve the property.

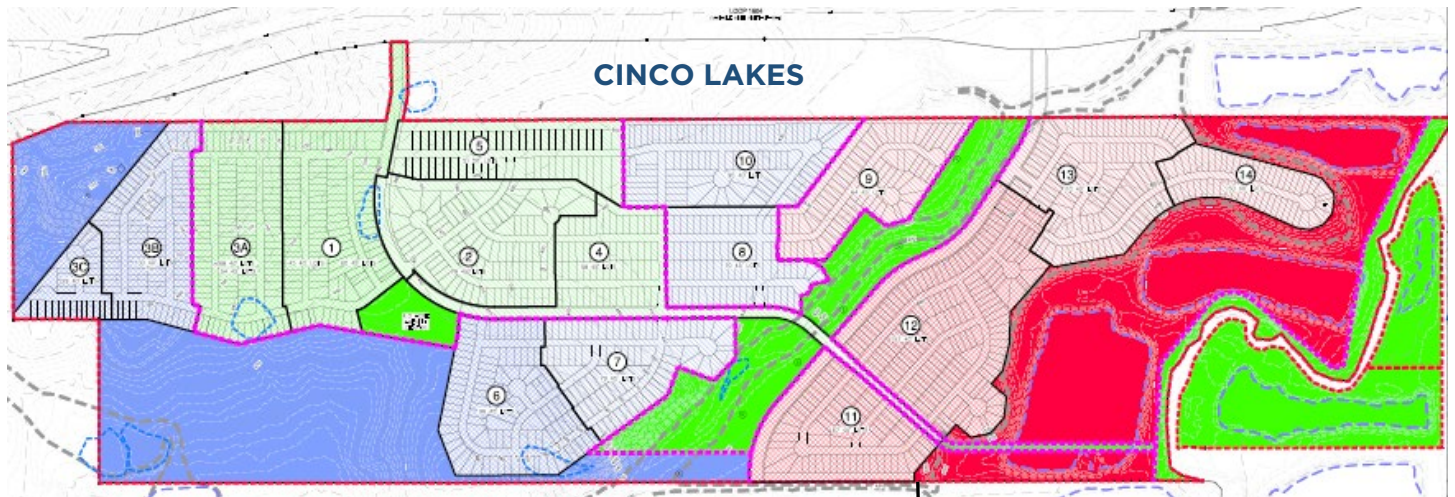

sullivansa.com
SULLIVAN COMMERCIAL REALTY
210 341 9292

Sullivan Commercial Realty does not guarantee the completeness or accuracy of the information contained herein and expressly disclaims any duty, warranty or representation, express or implied, related to this information or the property information.